



AIR-COOLED MIG GUNS



ALPHA® Catalog 2008
LIT.9137 August, 2008

Technology for the Welder's World.



Semi-Automatic Welding – with ABICOR BINZEL®

The Alpha Series of Semi-Automatic MIG Guns for ABICOR Binzel feature a modular design concept for interchangeability, providing lower operational costs and ease of inventory. Quality welding is performed by Alpha torches whose amperages range from 180 to 450 using CO₂.

Backing the product is a team of experts – both in our German headquarters and our subsidiaries around the world – ready for problems and custom-specific solutions. Along with installation, application and special training, our after-sales service includes the support and optimization of the production process. Quick spare parts supply and repairs are included in our personalized service.

Recognizing and co-creating innovative technological trends make ABICOR BINZEL® a leader in the welding industry.

Founded in 1945, Alexander Binzel Schweisstechnik GmbH & Co. KG specializes in the development and production of welding and cutting torches for the MIG, TIG, Robotics and Plasma processes.

ABICOR BINZEL® is represented in more than 50 countries with more than 900 employees, 30 production and sales companies, as well as over 20 exclusive partners.

Production facilities are located in Germany, USA, Brazil, Switzerland, India, China, and the Czech Republic.

TABLE OF CONTENTS

ALPHA Series, Air-Cooled MIG Guns w/Ratings	3
ALPHA Series, Cable Assembly/Rear Ends	3
ALPHA Series, Ordering Instructions	4
ALPHA Series, Swannecks	5,6
ALPHA Consumables: Nozzles	7
ALPHA Consumables: Contact Tips, Diffusers/Tip Holders	8
ALPHA Consumables: Neckliners, Liners	9
ALPHA 1 MIG Gun Parts - Body-Cable Assembly	10
ALPHA 2 MIG Gun Parts - Body-Cable Assembly	11
ALPHA 3 MIG Gun Parts - Body-Cable Assembly	12
ALPHA 4 MIG Gun Parts - Body-Cable Assembly	13
Connector Kit, Hobart/Tweco	14
Connector Kit, Lincoln	14
Connector Kit, Miller	15
Connector Kit, Lincoln 10	15
ALPHA Consumable Combinations	16,17

ALPHA® Series Air-Cooled MIG Guns

The ABICOR ALPHA Series of semiautomatic GMAW welding guns offers you LOWER OPERATIONAL COSTS with these welder-friendly features.

- Neck liners save wear on gun liners, providing gun liner cost savings.
- ABICOR Binzel Universal rear end connector kits for direct plugs or Euro quick-connections.

ALPHA Series MIG-Guns are available in 180, 250, 350, and 400 amperes with various configurations based on degree of swannecks, cable length, wire size and rear end connection. Refer to the detailed instruction on the page 4 to determine the ALPHA part number that best suits your requirements. If you have any questions, please contact Customer Service at 1.800.542.4867.

Ergonomically designed handle for comfort and ease of operation.

Slip-on and threaded nozzles available in the ALPHA Series:

ALPHA 1 - slip-on only
ALPHA 2 and 3 - slip-on or threaded,
ALPHA 4 - threaded or heavy duty threaded nozzles available.

ABICOR Binzel's signature BIKOX® power cable extruded to exact standards of quality and longevity.

Modular swannecks for fast replacement and interchangeability. Affordably priced to extend gun life.

Positionable 22°, 45° and 60° bend swannecks (60° standard) to give improved access to any job.

All Alpha swannecks are fully positionable (360 degrees, and interchangeable.

ALPHA® Series Air-Cooled MIG Guns



Type: **ALPHA 1**

Rating: 180 Amp Co2
150 Amp Mixed

60% Duty Cycle

Wire Sizes: .024"-.035"
(0.6mm-0.9mm)

Rated using power source with VDE standard volt/amp characteristic (U=14+0.05xl).

Type: **ALPHA 2**

Rating: 250 Amp Co2
200 Amp Mixed

60% Duty Cycle

Wire Sizes: .024"-.045"
(0.6mm-1.2mm)

Rated using power source with VDE standard volt/amp characteristic (U=14+0.05xl).

Type: **ALPHA 3**

Rating: 350 Amp Co2
300 Amp Mixed

60% Duty Cycle

Wire Sizes: .035"-.062"
(0.9mm-1.6mm)

Rated using power source with VDE standard volt/amp characteristic (U=14+0.05xl).

Type: **ALPHA 4**

Rating: 450 Amp Co2
400 Amp Mixed

60% Duty Cycle

Wire Sizes: .035"-.094"
(0.9mm-2.4mm)

Rated using power source with VDE standard volt/amp characteristic (U=14+0.05xl).

ALPHA® Series Cable Assembly/Rear Ends

Unlike most other MIG gun manufacturers, ABICOR Binzel extrudes its own power cable to exacting standards of quality and longevity.

All ABICOR ALPHA Series MIG guns use ABICOR's signature BIKOX® power cable with these features:

- Polyamide inner wire conduit for consistent gas coverage.
- Braided copper power cable incorporating trigger wires for multi-directional flexibility.
- Hydraulically compressed Bikox® fittings for durability and a permanent gas seal.

The ALPHA Series features two cable assembly rear end configurations: the Universal Connector for direct plugs or EURO Quick Connection (E).



Universal Connector rear end for direct plugs.
From top: Miller, Hobart/Tweco, Lincoln, Lincoln 10

BIKOX® Power Cable

Euro Quick Connector rear end

ALPHA® Series Air-Cooled MIG Gun

Ordering Information

ALPHA Series MIG-Guns are available in 180, 250, 350, and 400 amperes with various configurations based on degree of swannecks, cable length, nozzle bore size, wire size and rear end connection. Refer to the detailed instruction below to determine the ALPHA part number that best suits your requirements. If you have any questions, please contact Customer Service at 1.800.542.4867.

ORDERING INSTRUCTIONS FOR COMPLETE ALPHA AIR-COOLED GUNS

STANDARD ORDERING

OPTIONS

A3

15

T

- 3545

L1

C

TORCH MODELS

CABLE LENGTH

NOZZEL TYPE

WIRE SIZE

BACK END

HANDLE OPTIONS

TORCH MODEL

A1 = ALPHA 1 MIG GUN
 A2 = ALPHA 2 MIG GUN
 A3 = ALPHA 3 MIG GUN
 A4 = ALPHA 4 MIG GUN

CABLE LENGTH

AVAILABLE ON:

10 - 10 FT (A1-A4)
 12 - 12 FT (A1-A4)
 15 - 15 FT (A1-A4)
 20 - 20 FT (A2-A4)
 25 - 25 FT (A2-A4)

NOZZELS

T = THREADED
 NO LETTER = SLIP-ON (ALPHA 1, 2 & 3 ONLY)

WIRE SIZE

AVAILABLE ON:

3035 = .030" - .035" (A1 ONLY)
 3545 = .035" - .045" (A2-A4)
 116 = .052" - .062" (A3-A4)
 332 = .078" - .094" (A4 ONLY)

BACK END

L = LINCOLN EXTRNAL GAS
 L1 = LINCOLN 10
 HT = HOBART/TWECO
 M = MILLER
 E = EURO

NOTE: Standard 60 degree threaded neck.

HANDLE OPTIONS

C - COMPACT SMALL HANDLE & SHORT NECK
 L - LOCKING TRIGGER
 DS - DUAL SCEDULE w/ ROCKER SWITCH 4 WIRE
 DS1 - DUAL SCEDULE w/ ROCKER SWITCH 3 WIRE
 MS - DUAL SCEDULE w/ SINGLE PULL SWITCH 4 WIRE
 MS1 - DUAL SCEDULE w/ SINGLE PULL SWITCH 3 WIRE
 CMS - COMPACT DUAL SCHDULE w/SINGLE PULL SWITCH 4 WIRE

ALPHA® Series: Modular Swannecks

The ABICOR ALPHA Series features screw-on modular swannecks for fast and easy replacement. All ALPHA swannecks are fully positionable (360°) and interchangeable. Each ALPHA gun is supplied with a 60° bend swanneck as standard, and 22° and 45° configurations are available to provide maximum access.

The ALPHA 1 swannecks are designed for slip-on nozzles standard, while the ALPHA 2, 3 and 4 are configured with threaded nozzle swannecks standard. Optional slip-on swanneck assemblies available for the ALPHA 2 and 3.

All ALPHA swannecks use neck liners to save wear on the gun liners. Neck liners are available in steel for steel wire or brass for welding aluminum.

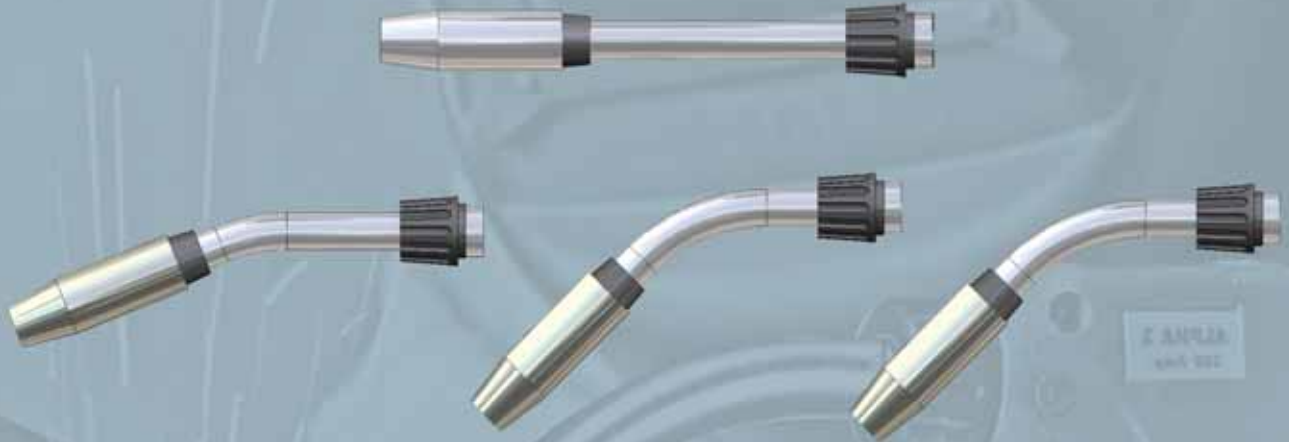

ALPHA® 1 and 3 Series: Lightweight Flexible Swannecks

Flexible Swannecks for those hard to reach welds! Runs .024-.035 steel or .030-.035 aluminum wire. Modular Swannecks for fast replacement and interchangeability. Positionable Alpha Swanneck improves access to any job. Neck Liners save wear on Gun Liners for added cost savings. Optional Gun Hanger for easier operator handling.

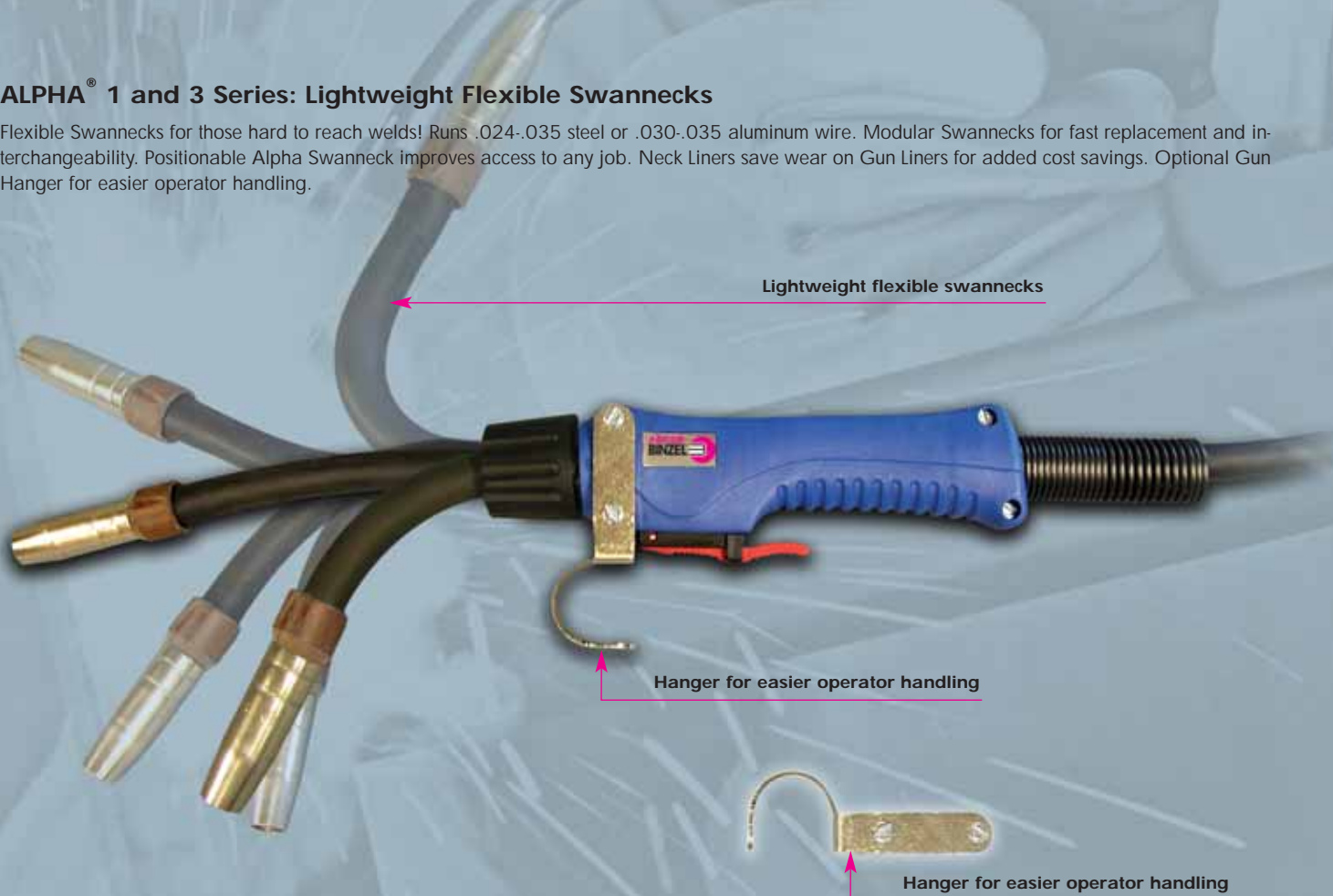

For more information about other flex-neck models, contact our Product Department at 1.800.542.4867.

ALPHA® Series MIG-Guns

Consumables: Swannecks

SWANNECKS

DESCRIPTION	ALPHA 1 PART NO.	ALPHA 2 PART NO.	ALPHA 3 PART NO.	ALPHA 4 PART NO.
-------------	---------------------	---------------------	---------------------	---------------------

Swanneck Assemblies: include Swanneck, Liner Collar, Tip Holder/Diffuser, Contact Tip, Nozzle, Neckliner

Swanneck Assy Slip-On 60 degree	A1-60	A2-60	A3-60	—
Swanneck Assy Slip-On 45 degree	A1-45	—	—	—
Swanneck Assy Slip-On 22 degree	A1-22	—	—	—
Swanneck Assy Threaded 60 degree	—	A2T-60	A3T-60	A4T-60
Swanneck Assy Threaded 45 degree	—	A2T-45	A3T-45	A4T-45
Swanneck Assy Threaded 22 degree	—	A2T-22	A3T-22	A4T-22
Swanneck Assy Threaded 60 degree short	—	A2T-60S	A3T-60S	A4T-60S
Swanneck Assy Threaded Heavy Duty 60 degree	—	—	—	A4T-60-HD
Swanneck Assy Threaded Heavy Duty 45 degree	—	—	—	A4T-45-HD
Swanneck Assy Threaded Heavy Duty 22 degree	—	—	—	A4T-22-HD

Swannecks Only: include Swanneck, Liner Collar, Tip Holder/Diffuser

Swanneck Slip-On 60 degree	002.D244*	—	—	—
Swanneck Slip-On 45 degree	002.D243*	—	—	—
Swanneck Slip-On 22 degree	002.D242*	—	—	—
Swanneck Threaded 60 degree	—	012.D097	014.D741	016.D147
Swanneck Threaded 45 degree	—	012.D096	014.D808	016.D223
Swanneck Threaded 22 degree	—	012.D095	014.D806	016.D221
Swanneck Threaded Heavy Duty 60 degree	—	—	—	016.D226
Swanneck Threaded Heavy Duty 45degree	—	—	—	016.D225
Swanneck Threaded Heavy Duty 22 degree	—	—	—	016.D224

* ALPHA 1 Swannecks include Tip Holder/Diffuser, Head Insulator, and Nozzle Retaining Spring.

Flex Necks

Flex Neck	A1-FX	—	A3T-FX	—
-----------	-------	---	--------	---

Swanneck Parts

Head Insulator	002.0050	012.D106	014.D746	016.D154
Swanneck Retaining Nut	014.D256	014.D256	014.D256	016.D193
Nozzle Retaining Spring	002.0058	—	—	—

ALPHA® Series MIG-Guns

Consumables:

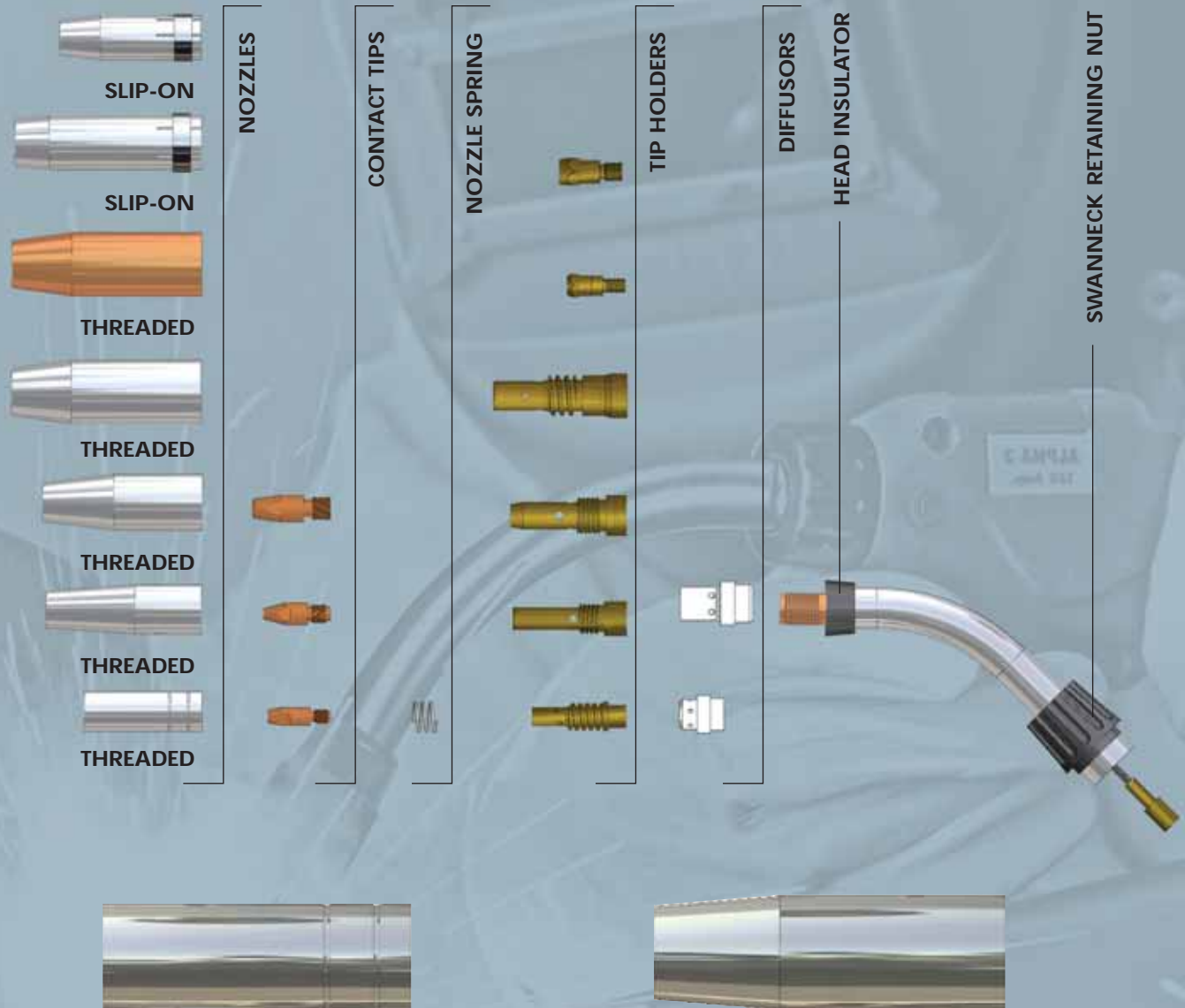

NOZZLES (packaged 5 per bag)

DESCRIPTION	ALPHA 2							
	ALPHA 1 SLIP-ON	ALPHA 2 SLIP-ON	ALPHA 2 HEAVY DUTY	ALPHA 2 THREADED	ALPHA 3 SLIP-ON	ALPHA 3 THREADED	ALPHA 4 THREADED	ALPHA 4 HEAVY DUTY
3/8" ID	145.0123	145.0128	—	—	—	—	—	—
1/2" ID	145.0075	145.0080	145.0101	—	145.0126	—	N4T-50	—
5/8" ID	145.0041	145.0047	145.0062	—	145.0078	—	N4T-62	N4T-HD-62
3/4" ID	—	—	—	—	145.0045	—	N4T-75	N4T-HD-75
w/Extra Insulation 1/2" ID	145.0107	—	—	—	—	—	—	—
w/Extra Insulation 5/8" ID	145.0067	—	—	—	—	—	—	—
1/2" ID Recess	—	—	—	N2TR-50	—	N3TR-50	—	—
9/16" ID Recess	—	—	—	N2TR-56	—	—	—	—
5/8" ID Recess	—	—	—	N2TR-62	—	N3TR-62	—	—
3/4" ID Recess	—	—	—	—	—	N3TR-75	—	—
3/8" ID Flush	—	—	—	N2TF-38	—	N3TF-38	—	—
1/2" ID Flush	—	—	—	N2TF-50	—	—	—	—
9/16" ID Flush	—	—	—	N2TF-56	—	N3TF-56	—	—
5/8" ID Flush	—	—	—	—	—	N3TF-62	—	—

ALPHA® Series MIG-Guns

Consumables: Contact Tips, Diffusers/Tip Holders

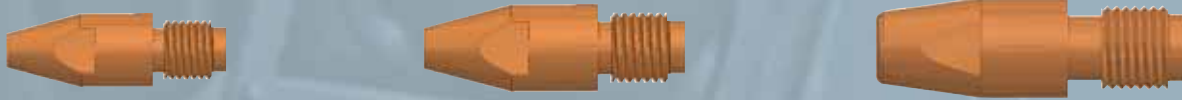

CONTACT TIPS (packaged 25 per bag)

STYLE	INCH	METRIC	ALPHA 1 M6 PART NO.	ALPHA 2 M6 PART NO.	ALPHA 3 M8 PART NO.	ALPHA 4 M8 PART NO.	ALPHA 4 M10 PART NO.
E - CU	.024	0.6	140.0005	—	—	—	—
E - CU	.030	0.8	140.0051	140.0051	—	—	—
E - CU	.035	0.9	140.0169	140.0169	140.0214	140.0214	—
E - CU	.040	1.1	—	140.0242	140.0313	140.0313	—
E - CU	.045	1.2	—	140.0379	140.0442	140.0442	—
E - CU	.052	1.4	—	—	140.0533	140.0533	—
E - CU	.062	1.6	—	—	140.0587	140.0587	—
E - CU	.078	1.8	—	—	—	140.0653	—
E - CU	.094	2.0	—	—	—	140.0677	—
E - CU for Aluminum	.030	0.8	141.0001	141.0001	—	—	—
E - CU for Aluminum	.035	0.9	141.0004	141.0004	141.0043	—	—
E - CU for Aluminum	.040	1.1	—	141.0006	141.0008	—	—
E - CU for Aluminum	.045	1.2	—	141.0010	141.0015	—	—
E - CU for Aluminum	.052	1.4	—	—	141.0055	—	—
E - CU for Aluminum	.062	1.6	—	—	141.0022	—	—
CuCrZr	.035	0.9	—	—	—	—	140.1248
CuCrZr	.040	1.1	—	—	—	—	140.0348
CuCrZr	.045	1.2	—	—	—	—	140.0481
CuCrZr	.052	1.4	—	—	—	—	140.0547
CuCrZr	.062	1.6	—	—	—	—	140.0616
CuCrZr	.078	1.8	—	—	—	—	140.0665
CuCrZr	.094	2.0	—	—	—	—	140.0698



DIFFUSER



TIP HOLDER



TIP HOLDER

DIFFUSORS/TIP HOLDERS (packaged 10 per bag)

DESCRIPTION	ALPHA 1 SLIP-ON	ALPHA 2 PART NO.	ALPHA 2 SLIP-ON	ALPHA 3 PART NO. PART NO.	ALPHA 3 SLIP-ON	ALPHA 4 PART NO. PART NO.
Tip Holder M6	002.0078	H2T-6	—	—	—	—
Tip Holder M8	—	—	—	H3T-8	—	H4T-8
Tip Holder M10 1/4" Recess	—	—	—	—	—	H4T-10
Diffusor	—	—	012.0017	—	014.0021	—
Diffusor Hi-Temp	—	—	—	—	014.0026	—
Tip Holder Recessed	—	—	142.0003	—	142.0020	—
Tip Holder Flush	—	—	142.0010	—	142.0024	—

ALPHA® Series MIG-Guns

Consumables: Neckliners, Liners

Steel



Aluminum



NECKLINERS

DESCRIPTION	ALPHA 1 PART NO.	ALPHA 2 PART NO.	ALPHA 3 PART NO.	ALPHA 4 PART NO.
Neckliner Steel .024"-.035"	S2435	S2435	—	—
Neckliner Steel .035"-.045"	—	S3545	S3545	S4-3545
Neckliner Steel .052"-.062"	—	—	S4562	S4-5262
Neckliner Brass .024"-.040" for aluminum	B2440	B2440	B2440	—
Neckliner Brass .040"-.052" for aluminum	—	B4052	B4052	—

Steel



C-TFE



LINERS

DESCRIPTION	WIRE SIZE	LENGTH	ALPHA 1 PART NO.	ALPHA 2 PART NO.	ALPHA 3 PART NO.	ALPHA 4 PART NO.
Liner Steel Insulated	.024" - .035" (.6mm-.9mm)	17 ft	SI-2435-17PT	SI-2435-17PT	—	—
Liner Steel Insulated	.035" - .045" (.9mm-1.2mm)	17 ft	—	SI-3545-17PT	SI-3545-17PT	SI4-3545-17PT
Liner Steel Insulated	.052" - .062" (1.4mm-1.6mm)	17 ft	—	—	SI-5262-17PT	SI4-5262-17PT
Liner Steel Insulated	.078" - .094" (2.0mm-2.4mm)	17 ft	—	—	—	SI4-7894-17PT
Liner Steel Insulated	.024" - .035" (.6mm-.9mm)	28 ft	—	SI-2435-28PT	—	—
Liner Steel Insulated	.035" - .045" (.9mm-1.2mm)	28 ft	—	SI-3545-28PT	SI-3545-28PT	SI4-3545-28PT
Liner Steel Insulated	.052" - .062" (1.4mm-1.6mm)	28 ft	—	—	SI-5262-28PT	SI4-5262-28PT
Liner Steel Insulated	.078" - .094" (2.0mm-2.4mm)	28 ft	—	—	—	SI4-7894-28PT
Liner Carbon C-TFE	.024" - .030" (.6mm-.8mm)	17 ft	127.9009	127.9009	—	—
Liner Carbon C-TFE	.035" - .045" (.9mm-1.2mm)	17 ft	127.9003	127.9003	127.9003	—
Liner Carbon C-TFE	.052" - .062" (1.4mm-1.6mm)	17 ft	—	—	127.9006	—
Liner Carbon C-TFE	.024" - .030" (.6mm-.8mm)	28 ft	—	127.9012	127.9012	—
Liner Carbon C-TFE	.035" - .045" (.9mm-1.2mm)	28 ft	—	127.9011	127.9011	—
Liner Carbon C-TFE	.052" - .062" (1.4mm-1.6mm)	28 ft	—	—	127.9010	—

ALPHA[®] 1 MIG-Gun

MIG Gun Parts List-Body-Cable Assembly

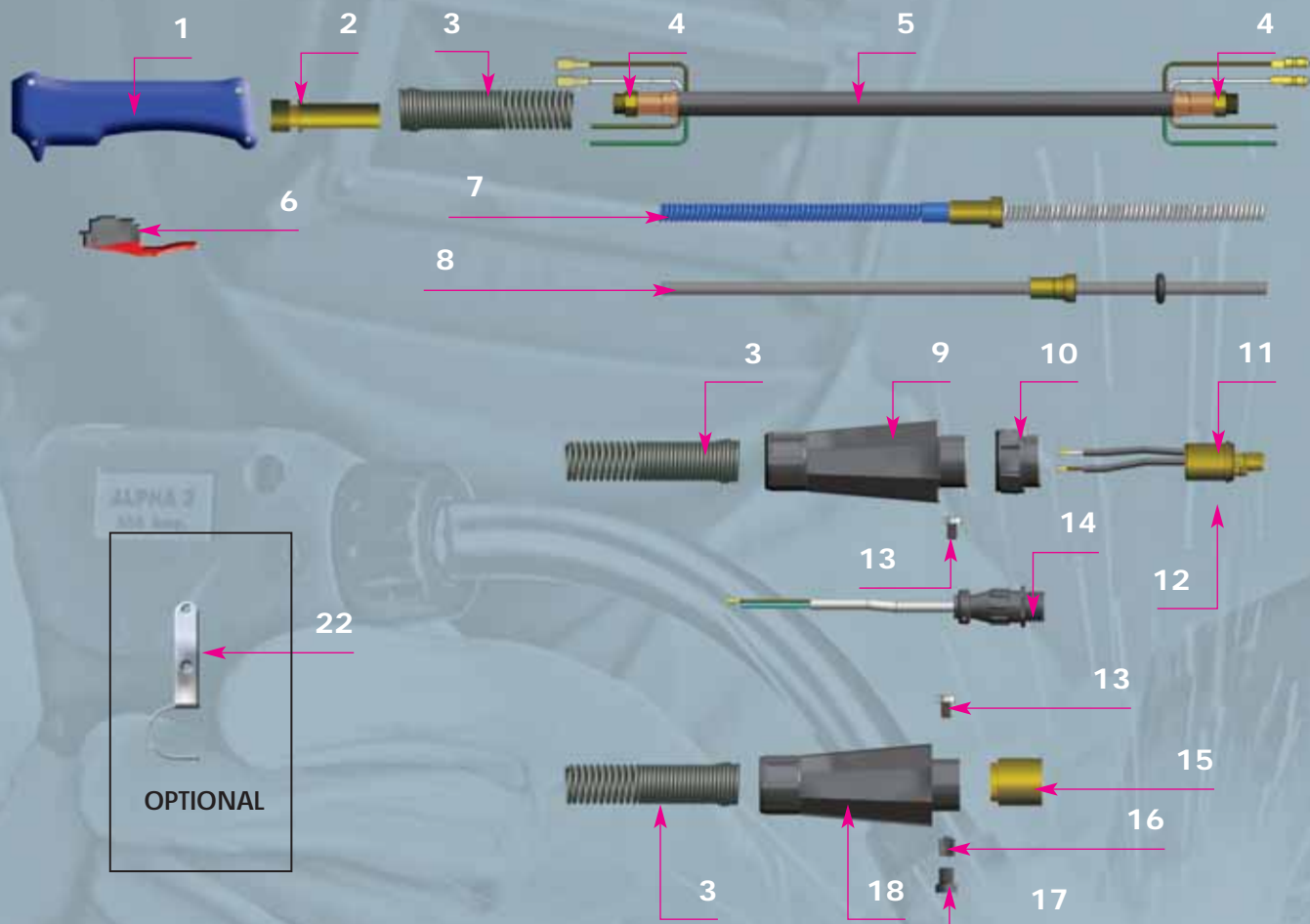

ITEM NO.	DESCRIPTION	PART NO.	ITEM NO.	DESCRIPTION	PART NO.
1	Handle ALPHA 1 (inc. trigger guard)	180.D026	8	Liner Carbon C-TFE .035-.045 (9.9mm-1.2mm) 17' (5M)	127.9003
2	Torch Body	004.D299	9	Rear Housing Complete, Euro	501.D508
3	Spring Cable Support	400.D205	10	Adaptor Nut	500.0213
4	Nut Lock Brass, M10 x 1	001.0009	11	Adaptor Block, Euro	501.0003
5	ALPHA 1 Bikox 10'	A1-10	12	Nut Liner Retaining	501.0082
5	ALPHA 1 Bikox 12'	A1-12	13	Screw Slotted Head, M4 x 6	000.0552
5	ALPHA 1 Bikox 15'	A1-15	14	Plug Amp Female 4-Pin (with 4-wire cable)	175.D050
6	Trigger Switch Bladed (factory standard)	185.D065	15	Adaptor Block, Direct (inc. 13, 16 & 17)	501.D333
N/S	Trigger Guard	400.D252	16	Set Screw Hex Head M5 x 5	009.0136
N/S	Trigger Switch Assy	185.D078	17	Gas Seal	001.D092
N/S	Trigger Switch Assy Extended	185.D053	18	Rear Housing Complete, Direct	501.D501
7	Liner Steel Insulated .024-.035 (.6mm-.9mm) 17' (5M)	SI-2435-17PT	22	Gun Hanger ALPHA 1-4 (optional)	400.D256
8	Liner Carbon C-TFE .024-.030 (.6mm-.8mm) 17' (5M)	127.9009	N/S	Wrench	191.0001
N/S = Not Shown					

ALPHA[®] 2 MIG-Gun

MIG Gun Parts List-Body-Cable Assembly

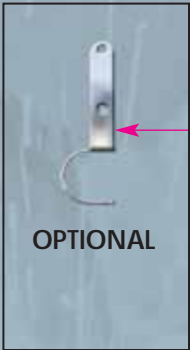

ITEM NO.	DESCRIPTION	PART NO.	ITEM NO.	DESCRIPTION	PART NO.
1	Handle ALPHA 2 (inc. trigger guard)	180.D026	8	Liner Carbon C-TFE .024-.030 (.6mm-.8mm) 17' (5M)	127.9009
2	Torch Body	004.D299	8	Liner Carbon C-TFE .035-.045 (.9mm-1.2mm) 17' (5M)	127.9003
3	Spring Cable Support	400.D205	8	Liner Carbon C-TFE .024-.030 (.6mm-.8mm) 28' (8.5M)	127.9012
4	Nut Lock Brass, M10 x 1	001.0009	8	Liner Carbon C-TFE .035-.045 (.9mm-1.2mm) 28' (8.5M)	127.9011
5	ALPHA 2 Bikox 10'	A2-10	9	Rear Housing Complete, Euro	501.D508
5	ALPHA 2 Bikox 12'	A2-12	10	Adapter Nut	500.0213
5	ALPHA 2 Bikox 15'	A2-15	11	Adapter Block, Euro	501.0003
5	ALPHA 2 Bikox 20'	A2-20	12	Nut Liner Retaining	501.0082
5	ALPHA 2 Bikox 25'	A2-25	13	Screw Slotted Head, M4 x 6	000.0552
6	Trigger Switch Assembly Bladed (factory standard)	185.D065	14	Plug Amp Female 4-Pin (with 4-wire cable)	175.D050
N/S	Trigger Guard	400.D252	15	Adapter Block, Direct (inc. 13, 16 & 17)	501.D333
N/S	Trigger Switch Assembly Extended Plastic (optional)	185.D053	16	Set Screw Hex Head M5 x 5	009.0136
N/S	Trigger Switch Assy	185.D078	17	Gas Seal	001.D092
7	Liner Steel Insulated .024-.035 (.6mm-.9mm) 17' (5M)	SI-2435-17PT	18	Rear Housing Complete, Direct	501.D501
7	Liner Steel Insulated .035-.045 (.9mm-1.2mm) 17' (5M)	SI-3545-17PT	22	Gun Hanger ALPHA 1-4 (optional)	400.D256
7	Liner Steel Insulated .024-.035 (.6mm-.9mm) 28' (8.5M)	SI-2435-28PT	N/S	Wrench	191.0001
7	Liner Steel Insulated .035-.045 (.9mm-1.2mm) 28' (8.5M)	SI-3545-28PT			

N/S = Not Shown

ALPHA® 3 MIG-Gun

MIG Gun Parts List-Body-Cable Assembly



ITEM NO.	DESCRIPTION	PART NO.	ITEM NO.	DESCRIPTION	PART NO.
1	Handle ALPHA 3 & 4 (inc. trigger guard)	180.D024	11	Liner Carbon C-TFE .035-.045 (.9mm-1.2mm) 17' (5M)	127.9003
2	Switch Plate	400.0359	11	Liner Carbon C-TFE .052-.062 (1.4mm-1.6mm) 17' (5M)	127.9006
3	Screw Pan Head, M4 x 10	400.0792	11	Liner Carbon C-TFE .035-.045 (.9mm-1.2mm) 28' (8.5M)	127.9011
4	Nut Insertion M4 x 10	400.0095	11	Liner Carbon C-TFE .052-.062 (1.4mm-1.6mm) 28' (8.5M)	127.9010
5	Torch Body - Standard & Compact	004.D299	12	Rear Housing Complete, Euro	501.D508
7	ALPHA 3 Bikox 10' (Includes spring supports)	A3-10	13	Adaptor Nut	500.0213
7	ALPHA 3 Bikox 12' (Includes spring supports)	A3-12	14	Adaptor Block, Euro	501.0003
7	ALPHA 3 Bikox 15' (Includes spring supports)	A3-15	15	Nut Liner Retaining	501.0082
7	ALPHA 3 Bikox 20' (Includes spring supports)	A3-20	16	Screw Slotted Head, M4 x 6	000.0552
7	ALPHA 3 Bikox 25' (Includes spring supports)	A3-25	17	Plug Amp Female 4-Pin (with 4-wire cable)	175.D050
8	Trigger Switch Assembly Bladed (factory standard)	185.9059	18	Adaptor Block, Direct (inc. 16, 19 & 20)	501.D333
9	Trigger Housing Plastic	400.9116	19	Set Screw Hex Head M5 x 5	009.0136
9.1	Dual Schedule Trigger Assy.	185.9058	20	Gas Seal	001.D092
9.2	Trigger Switch Assy. Locking	185.9054	21	Rear Housing Complete, Direct	501.D501
N/S	Trigger Switch Assy. Blade (Standard)	400.9117	22	Handle Compact	180.D026
N/S	Trigger Switch Assembly Extended Aluminum (optional)	185.D053	24	Heat Shield Kit	181.D001
10	Liner Steel Insulated .035-.045 (.9mm-1.2mm) 17' (5M)	SI-3545-17PT	25	Gun Hanger ALPHA 1-4 (optional)	400.D256
10	Liner Steel Insulated .052-.062 (1.4mm-2.0mm) 17' (5M)	SI-5262-17PT	26	Bikox Repair Kit	400.D337
10	Liner Steel Insulated .035-.045 (.9mm-1.2mm) 28' (8.5M)	SI-3545-28PT	N/S	Wrench	191.0001
10	Liner Steel Insulated .052-.062 (1.4mm-2.0mm) 28' (8.5M)	SI-5262-28PT	N/S	N/S = Not Shown	

ALPHA® 4 MIG-Gun

MIG Gun Parts List-Body-Cable Assembly

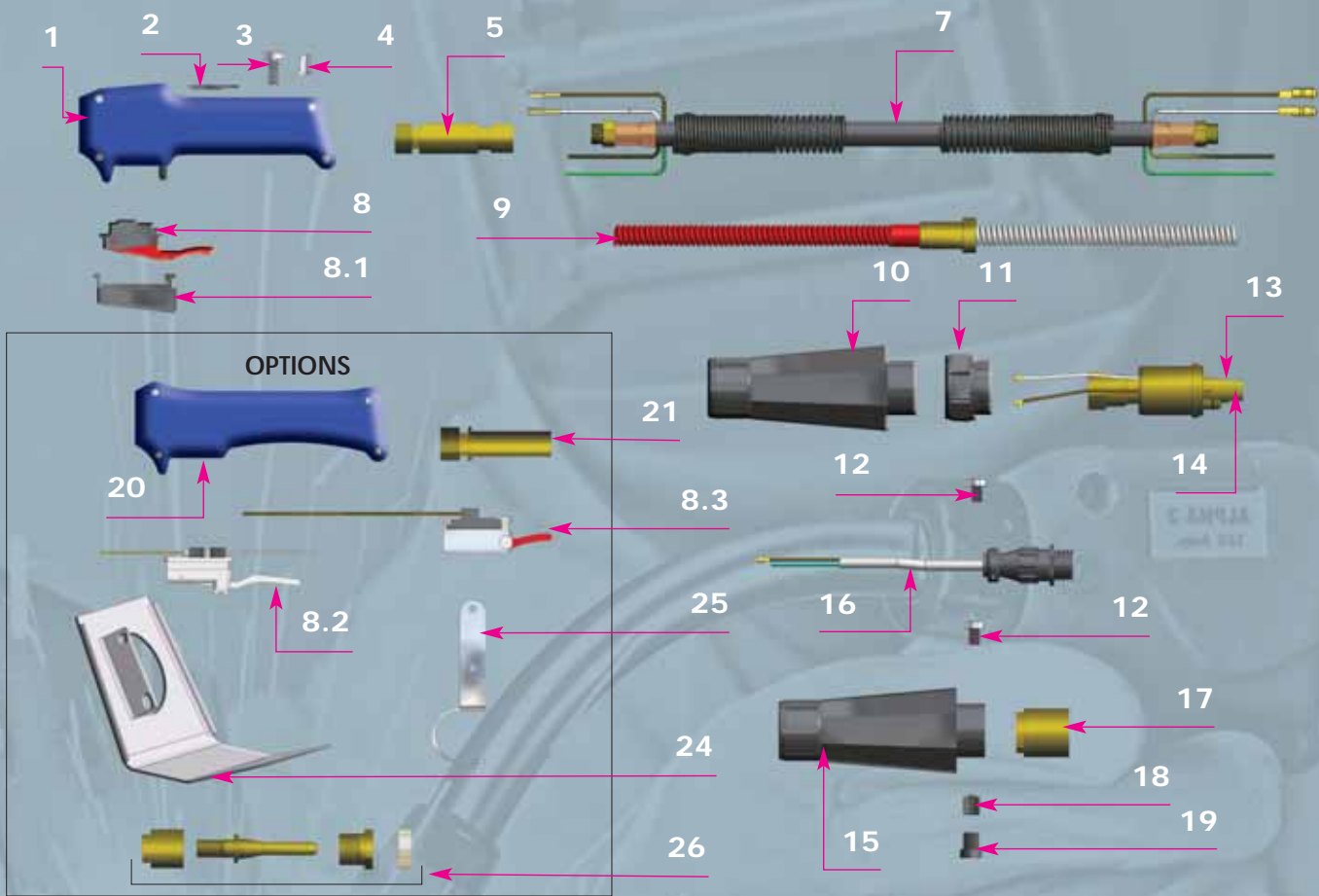

ITEM NO.	DESCRIPTION	PART NO.	ITEM NO.	DESCRIPTION	PART NO.
1	Handle ALPHA 3 & 4 (inc. trigger guard)	180.D024	9	Liner Insulated .035-.045 (.9mm-1.2mm) 28' (8.5M)	SI4-3545-28PT
2	Switch Plate	400.0359	9	Liner Insulated .052-.062 (1.4mm-1.6mm) 28' (8.5M)	SI4-5262-28PT
3	Screw Pan Head, M4 x 10	400.0792	9	Liner Insulated .078-.094 (2.0mm-2.4mm) 28' (8.5M)	SI4-7894-28PT
4	Nut Insertion M4 x 10	400.0095	10	Rear Housing Complete, Euro	501.2248
5	Torch Body	016.D121	11	Adapter Nut	500.0213
7	ALPHA 4 Bikox 10' (Includes spring supports)	A4-10	12	Screw Slotted Head, M4 x 6	000.0552
7	ALPHA 4 Bikox 12' (Includes spring supports)	A4-12	13	Adapter Block, Euro	501.D342
7	ALPHA 4 Bikox 15' (Includes spring supports)	A4-15	14	Nut Liner Retaining M14 x 1	501.0129
7	ALPHA 4 Bikox 20' (Includes spring supports)	A4-20	15	Rear Housing Complete, Direct	501.D501
7	ALPHA 4 Bikox 25' (Includes spring supports)	A4-25	16	Plug Amp Female 4-Pin (with 4-wire cable)	175.D050
N/S	Trigger Switch Assembly Extended Aluminum (optional)	185.D053	17	Adapter Block, Direct (inc. 12, 18 & 19)	501.D341
8	Trigger Switch Plastic (factory standard)	185.9059	18	Set Screw Hex Head M5 x 5	009.0136
8.1	Trigger Housing	400.9116	19	Gas Seal	001.D092
8.2	Dual Schedule Trigger Assy	185.9058	20	Handle Compact	180.D036
8.3	Trigger Switch Assy. Locking	185.9054	21	Torch Body Compact	016.D299
N/S	Trigger Switch Assy. Bladed (Standard)	400.9117	24	Heat Shield Kit	181.D001
N/S	Trigger Switch Assy. Extended Plastic	185.D053	25	Gun Hanger ALPHA 1-4 (optional)	400.D256
9	Liner Insulated .035-.045 (.9mm-1.2mm) 17' (5M)	SI4-3545-17PT	26	Bikox Repair Kit	400.D337
9	Liner Insulated .052-.062 (1.4mm-1.6mm) 17' (5M)	SI4-5262-17PT	N/S	Wrench	191.0001
9	Liner Insulated .078-.094 (2.0mm-2.4mm) 17' (5M)	SI4-7894-17PT	N/S =	Not Shown	

Connector Kits and Parts

Shown are the most popular Connector Kits

ALPHA Mig-Gun Direct Plug Connector Kit: Hobart/Tweco

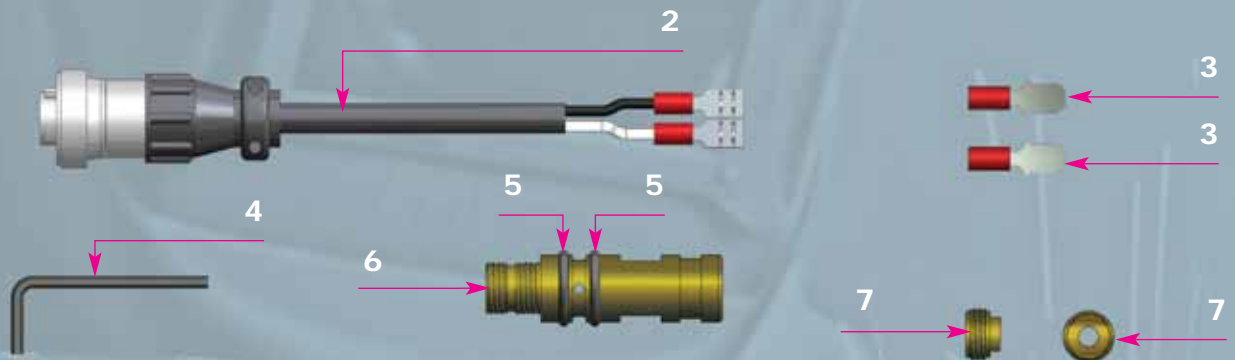

ITEM NO.	DESCRIPTION	ALPHA 1 PART NO.	ALPHA 2 PART NO.	ALPHA 3 PART NO.	ALPHA 4 PART NO.
1	Connector Kit, Hobart/Tweco	CK-HT	CK-HT	CK-HT	CK4-HT
2	Trigger Lead Jumper HT	175.9066	175.9066	175.9066	175.9066
3	Connector Wire 1/4" Male	175.9074	175.9074	175.9074	175.9074
4	Allen Wrench 2.5 mm	191.0017	191.0017	191.0017	191.0017
5	O-Rings (2 required)	165.0025	165.0025	165.0025	165.0025
6	Connector Plug HT	331.9003	331.9003	331.9003	501.9246
7	Liner Nut HT/LN	272.9017	272.9017	272.9017	272.9035

ALPHA Mig-Gun Direct Plug Connector Kit: Lincoln

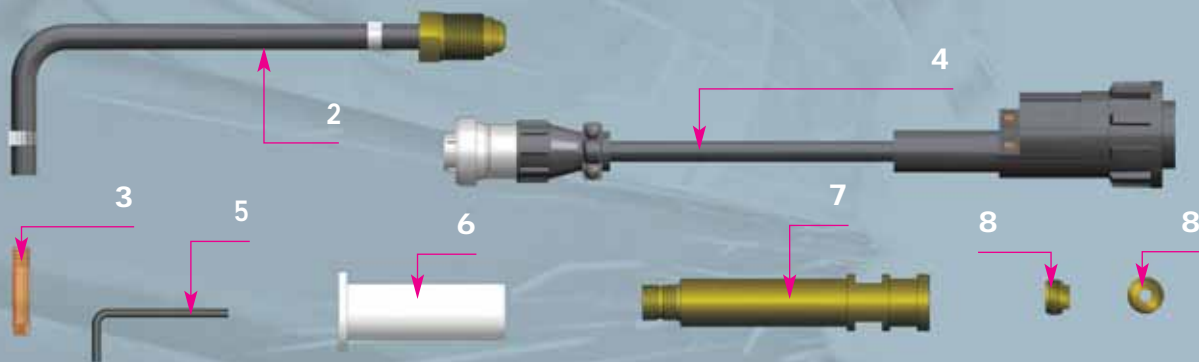

ITEM NO.	DESCRIPTION	ALPHA 1 PART NO.	ALPHA 2 PART NO.	ALPHA 3 PART NO.	ALPHA 4 PART NO.
1	Connector Kit, Lincoln	CK-L	CK-L	CK-L	CK4-L
2	Gas Hose Assembly	102.9149	102.9149	102.9149	102.9149
3	Gas Fitting with M6 THD	353.0002	353.0002	353.0002	353.0002
4	Trigger Lead Jumper LN	175.9067	175.9067	175.9067	175.9067
5	Allen Wrench 2.5 mm	191.0017	191.0017	191.0017	191.0017
6	Insulator Bushing	AC2030	AC2030	AC2030	AC2030
7	Connector Plug L	501.9191	501.9191	501.9191	501.9241
8	Liner Nut HT/LN	272.9017	272.9017	272.9017	272.9035

Connector Kits and Parts

Shown are the most popular Connector Kits

ALPHA Mig-Gun Direct Plug Connector Kit: Miller

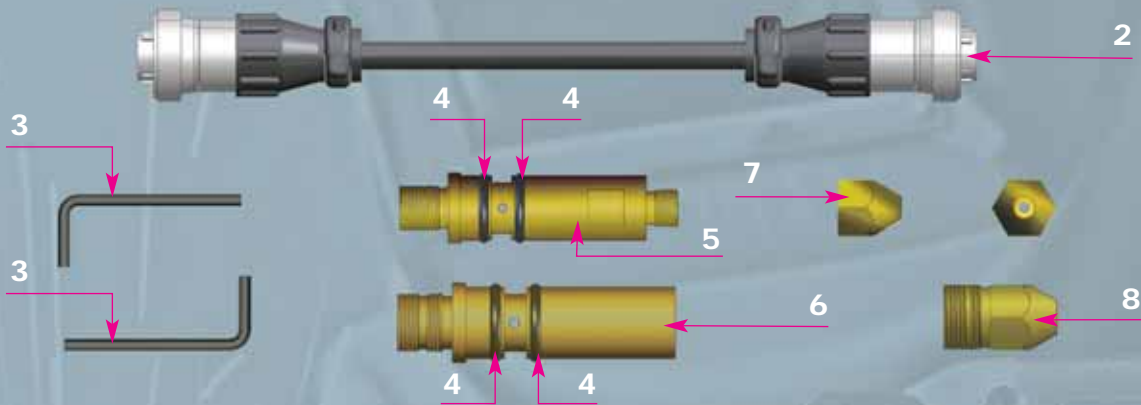

ITEM NO.	DESCRIPTION	ALPHA 1 PART NO.	ALPHA 2 PART NO.	ALPHA 3 PART NO.	ALPHA 4 PART NO.
1	Connector Kit, Miller	CK-M	CK-M	CK-M	CK4-M
2	Trigger Lead Jumper MR	175.9068	175.9068	175.9068	175.9068
3	Allen Wrench 2.5 mm	191.0017	191.0017	191.0017	191.0017
4	O-Rings (2 required)	165.9006	165.9006	165.9006	165.9006
5	Connector Plug Miller (ALPHA 1, 2, 3)	501.9183	501.9183	501.9183	-
6	Connector Plug Miller (ALPHA 4)	-	-	-	501.9245
7	Liner Nut MR (ALPHA 1, 2, 3)	272.9018	272.9018	272.9018	-
8	Liner Nut MR (ALPHA 4)	-	-	-	272.9036

ALPHA Mig-Gun Direct Plug Connector Kit: Lincoln 10

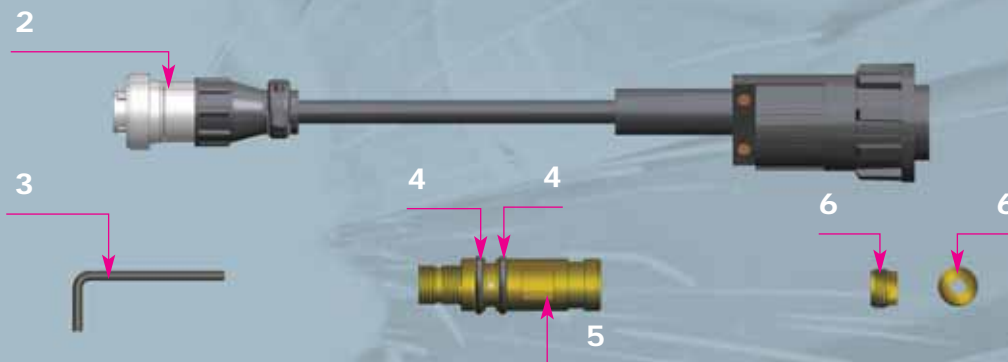

ITEM NO.	DESCRIPTION	ALPHA 1 PART NO.	ALPHA 2 PART NO.	ALPHA 3 PART NO.	ALPHA 4 PART NO.
1	Connector Kit, Lincoln Series	CK-L1	CK-L1	CK-L1	CK4-L1
2	Trigger Lead Jumper LN	175.9067	175.9067	175.9067	175.9067
3	Allen Wrench 2.5 mm	191.0017	191.0017	191.0017	191.0017
4	O-Rings (2 required)	165.0025	165.0025	165.0025	165.0025
5	Connector Plug HT	331.9003	331.9003	331.9003	501.9246
6	Liner Nut HT/LN	272.9017	272.9017	272.9017	272.9035

Alpha Consumable Combinations

ALPHA 1 SLIP-ON NOZZLE: CONSUMABLE COMBINATIONS

ALPHA 1 Slip-On	Wire Size Type	Contact Tip Part #	Tip Holder Part #	Diffusor Part #	Nozzle Part #	Neck Liner Part #	Cable Liner Part #
	.024 Steel	140.0005	N/A	N/A	145.0075	S2435	SI-2435-17PT
	.030 Steel	140.0051	N/A	N/A	145.0075	S2435	SI-2435-17PT
<i>Factory Set-up</i>	.035 Steel	140.0169	N/A	N/A	145.0075	S2435	SI-2435-17PT
	.030 Aluminum	141.0001	N/A	N/A	145.0075	B2440	127.9009
	.035 Aluminum	141.0004	N/A	N/A	145.0075	B2440	127.9003

Note: The ALPHA 1 is available with a slip-on nozzle only

ALPHA 2 THREADED NOZZLE: CONSUMABLE COMBINATIONS

ALPHA 2 Threaded	Wire Size Type	Contact Tip Part #	Tip Holder Part #	Diffusor Part #	Nozzle Part #	Neck Liner Part #	Cable Liner Part #
	.030 Steel	140.0051	H2T-6	N/A	N2T-R-50	S2435	SI-2435-17PT
	.035 Steel	140.0169	H2T-6	N/A	N2T-R-50	S3545	SI-3545-17PT
	.040 Steel	140.0242	H2T-6	N/A	N2T-R-50	S3545	SI-3545-17PT
<i>Factory Set-up</i>	.045 Steel	140.0379	H2T-6	N/A	N2T-R-50	S3545	SI-3545-17PT
	.030 Aluminum	141.0001	H2T-6	N/A	N2T-R-50	B2440	127.9009
	.035 Aluminum	141.0004	H2T-6	N/A	N2T-R-50	B2440	127.9003
	.040 Aluminum	141.0006	H2T-6	N/A	N2T-R-50	B4052	127.9003
	.045 Aluminum	141.0010	H2T-6	N/A	N2T-R-50	B4052	127.9003

ALPHA 2 SLIP-ON NOZZLE: CONSUMABLE COMBINATIONS

ALPHA 2 Slip-on	Wire Size Type	Contact Tip Part #	Tip Holder Part #	Diffusor Part #	Nozzle Part #	Neck Liner Part #	Cable Liner Part #
	.030 Steel	140.0051	142.0003	012.0017	145.0080	S2435	SI-2435-17PT
	.035 Steel	140.0169	142.0003	012.0017	145.0080	S3545	SI-3545-17PT
	.040 Steel	140.0242	142.0003	012.0017	145.0080	S3545	SI-3545-17PT
	.045 Steel	140.0379	142.0003	012.0017	145.0080	S4562	SI-3545-17PT
	.030 Aluminum	141.0001	142.0003	012.0017	145.0080	B2440	127.9009
	.035 Aluminum	141.0004	142.0003	012.0017	145.0080	B2440	127.9003

ALPHA 3 THREADED NOZZLE: CONSUMABLE COMBINATIONS

ALPHA 3 Threaded	Wire Size Type	Contact Tip Part #	Tip Holder Part #	Diffusor Part #	Nozzle Part #	Neck Liner Part #	Cable Liner Part #
	.035 Steel	140.0214	H3T-8	N/A	N3T-R-62	S3545	SI-3545-17PT
	.040 Steel	140.0313	H3T-8	N/A	N3T-R-62	S3545	SI-3545-17PT
<i>Factory Set-up for 034-045</i>	.045 Steel	140.0442	H3T-8	N/A	N3T-R-62	S3545	SI-3545-17PT
	.052 Steel	140.0533	H3T-8	N/A	N3T-R-62	S4562	SI-5262-17PT
<i>Factory Set-up for 1/16"</i>	.062 Steel	140.0587	H3T-8	N/A	N3T-R-62	S4562	SI-5262-17PT
	.035 Aluminum	141.0043	H3T-8	N/A	N3T-R-62	B2440	127.9003
	.040 Aluminum	141.0008	H3T-8	N/A	N3T-R-62	B4052	127.9003
	.045 Aluminum	141.0015	H3T-8	N/A	N3T-R-62	B4052	127.9003
	.052 Aluminum	141.0055	H3T-8	N/A	N3T-R-62	B4052	127.9006

Alpha Consumable Combinations

ALPHA 3 SLIP-ON NOZZLE: CONSUMABLE COMBINATIONS

ALPHA 3 Slip-on	Wire Size Type	Contact Tip Part #	Tip Holder Part #	Diffusor Part #	Nozzle Part #	Neck Liner Part #	Cable Liner Part #
	.035 Steel	140.0214	142.0020	014.0021	145.0078	S3545	SI-3545-17PT
	.040 Steel	140.0313	142.0020	014.0021	145.0078	S3545	SI-3545-17PT
<i>Factory Set-up for 034-045</i>	.045 Steel	140.0442	142.0020	014.0021	145.0078	S3545	SI-3545-17PT
	.052 Steel	140.0533	142.0020	014.0021	145.0078	S4562	SI-5262-17PT
<i>Factory Set-up for 052-062</i>	.062 Steel	140.0587	142.0020	014.0021	145.0078	S4562	SI-5262-17PT
	.035 Aluminum	141.0043	142.0020	014.0021	145.0078	B2440	127.9003
	.040 Aluminum	141.0008	142.0020	014.0021	145.0078	B4052	127.9003
	.045 Aluminum	141.0015	142.0020	014.0021	145.0078	B4052	127.9003
	.052 Aluminum	141.0055	142.0020	014.0021	145.0078	B4052	127.9006

ALPHA 4 MIG GUN: CONSUMABLE COMBINATIONS THREADED STANDARD VERSION

ALPHA 4 Standard	Wire Size Type	Contact Tip Part #	Tip Holder Part #	Diffusor Part #	Nozzle Part #	Neck Liner Part #	Cable Liner Part #
	.035 Steel	140.0214	H4T-8	N/A	N4T-62	S4-3545	SI4-3545-17PT
<i>Factory Set-up for 035-045</i>	.040 Steel	140.0313	H4T-8	N/A	N4T-62	S4-3545	SI4-3545-17PT
	.045 Steel	140.0442	H4T-8	N/A	N4T-62	S4-3545	SI4-3545-17PT
<i>Factory Set-up for 052-062</i>	.052 Steel	140.0533	H4T-8	N/A	N4T-62	S4-5262	SI4-5262-17PT
	.062 Steel	140.0587	H4T-8	N/A	N4T-62	S4-5262	SI4-5262-17PT
<i>Factory Set-up for 078-094</i>	.078 Steel	140.0653	H4T-8	N/A	N4T-62	N/A	SI4-7894-17PT
	.094 Steel	140.0677	H4T-8	N/A	N4T-62	N/A	SI4-7894-17PT

* When using .078" - .094" wire, do not use a neck liner. Instead run the cable liner up to the contact tip.

ALPHA 4 MIG GUN: CONSUMABLE COMBINATIONS THREADED HEAVY-DUTY VERSION

ALPHA 4 Heavy-Duty	Wire Size Type	Contact Tip Part #	Tip Holder Part #	Diffusor Part #	Nozzle Part #	Neck Liner Part #	Cable Liner Part #
	.035 Steel	140.1248	H4T-10	N/A	N4T-62	S4-3545	SI4-3545-17PT
	.040 Steel	140.0348	H4T-10	N/A	N4T-62	S4-3545	SI4-3545-17PT
	.045 Steel	140.0481	H4T-10	N/A	N4T-62	S4-3545	SI4-3545-17PT
	.052 Steel	140.0547	H4T-10	N/A	N4T-62	S4-5262	SI4-5262-17PT
	.062 Steel	140.0616	H4T-10	N/A	N4T-62	S4-5262	SI4-5262-17PT
	.078 Steel	140.0665	H4T-10	N/A	N4T-62	N/A	SI4-7894-17PT
	.094 Steel	140.0698	H4T-10	N/A	N4T-62	N/A	SI4-7894-17PT

* When using .078" - .094" wire, do not use a neck liner. Instead run the cable liner up to the contact tip.



Our product range:

■ MIG/MAG

- Welding Torches
- Automatic and Special Torches
- Push-Pull Welding Torches
- Fume Extraction Torches
- Central Adaptor System

■ TIG

- Welding Torches
- Automatic and Special Torches

■ PLASMA

- Cutting Torches
- Welding Torches
- Automatic and Special Torches

■ Robotic Peripheral Equipment

- Robot Torches
MIG/TIG/Plasma
- Robot Mount CAT2
- Torch Change System ATS-Rotor
- Wire Cutting Station WCS
- Torch Cleaning Station
BRS-LC and BRS-FP
- Laser Wire Feeding Systems

■ Welding Accessories

- Cooling Device
- Welding Cable Plug and Socket
- Anti Spatter Spray

and so on ...

Technology for the Welder's World.

Alexander Binzel Corporation
650 Medimmune Ct., Suite 110
Frederick, MD 21703-8619
Tel: 301.846.4196
Fax: 301.846.4497
www.abicorusa.com

BINZEL, S.A. DE C.V.
Municipio de Pabellon de Arteaga 102
Valle de Aguascalientes, 20358
San Francisco de los Romo, Ags. MEXICO
Tel: +52(499) 9730133
Fax: +52(449) 9731388
E-mail: www.binzel.com.mx

Abicor Binzel Canada, Inc.
55 Mills Road, Units 1-3
Ajax, Ontario L1S 2H2 Canada
Tel: 905.428.1611
Fax: 905.428.1598
Email: information@binzel.ca



www.abicorusa.com